

# Daniamant



## L90 LED Lifebuoy Light

Installation and Maintenance Instructions



### Description

The L90 LED lifebuoy light is a dry cell powered light equipped with a tilt switch for automatic function. It operates for more than two hours with a light intensity of at least 2 candelas.

### Daniamant Limited

Unit 3, The Admiral Park, Airport Service Road, Portsmouth, UK PO3 5RQ  
Telephone: +44 (0)23 9267 5100 Facsimile: +44 (0)23 9267 5101  
[www.daniamant.com](http://www.daniamant.com)

## General

A lifebuoy light marks the position of a lifebuoy. It is attached to the lifebuoys on board the ship. In case of a man overboard, the lifebuoy will be thrown overboard together with the lifebuoy light. It marks the position of the lifebuoy for the person who has gone overboard and for the ship or the rescue boat.

## Stowage

Lifebuoy lights are provided on ships (a lifebuoy light is connected to every second lifebuoy; minimum is 2 lifebuoy lights per ship).

The L90 LED Lifebuoy Light has been constructed to withstand a drop into the water from at least 30M as required by LSA Code (Chapter II, Section 2.1.1.6). This model has been tested and approved to 76M.

Maximum stowage height: 76M

## Instructions for use

### Initial fitting

For units supplied with batteries, to avoid battery drain in transit, an insulating disc is fitted to the battery pack. When the L90 LED is initially fitted to the vessel, ensure that the insulating disc is removed from the batteries as per the following instructions.

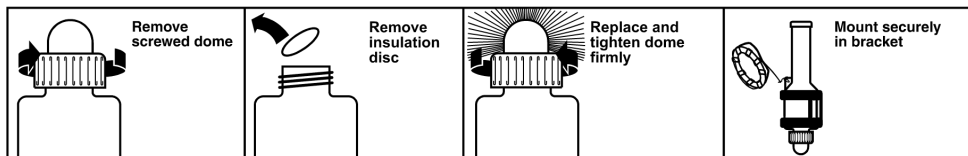

The above instructions are also printed on the body of the lifebuoy light

Clearly mark on the body of the lifebuoy light, in the space provided, the date for replacing the batteries, one year from installation.

Install lifebuoy light into bracket with the light in an inverted position.

Tie the lanyard to the lifebuoy.

In case of an emergency (man overboard) throw the light overboard together with the lifebuoy.

## Characteristics

<b>Light output</b>	2 Cd minimum for 2 hours
<b>Length</b>	380mm
<b>Weight</b>	1080g
<b>Batteries</b>	5 1.5 Volt LR20
<b>Activation</b>	Self-activating by tilt switch
<b>Connecting Line</b>	Unit comes complete with lanyard.

The light will only function when upright.

Fasten to vessel only with L90 LED mounting bracket.

## Maintenance

The L90 LED uses five standard LR20 Alkaline batteries as its power source. These need to be replaced on a yearly basis to ensure proper function of the light. Ensure that the batteries are fitted correctly as per diagram below. When replacing batteries, always use one of the following brands:-

- Duracell®
- Panasonic®
- Varta®

Clearly mark on the body of the lifebuoy light, in the space provided, the date for replacing the batteries, one year from installation.

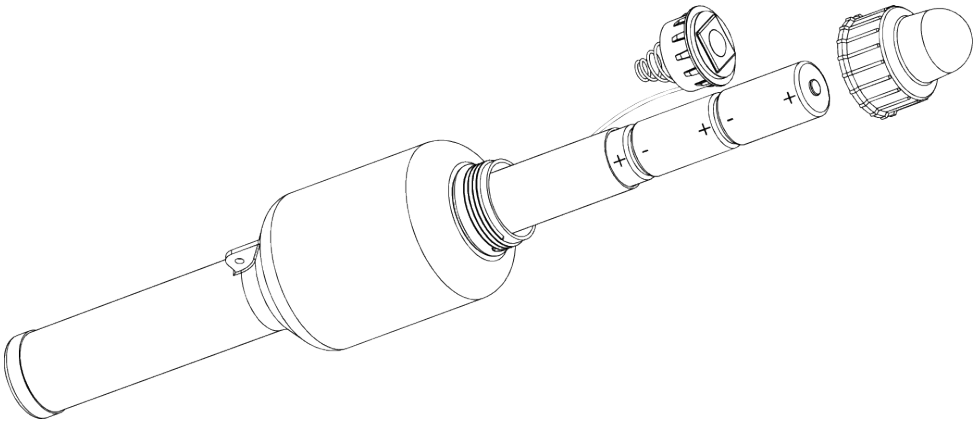

The following spares are available to support the L90 LED.

- L90 LED Bracket Part Number 63-4003
- L90 LED Dome Part Number 63-4001
- L90 LED Sealing Ring Part Number 63-8005

Whenever the L90 LED dome is replaced, the L90 LED Sealing Ring must be replaced at the same time. All spares are held at key distributors around the world.

## Health and Safety information

Information on the composition and behaviour of these products is contained in the Product Safety Data Sheet, available from our website ([www.daniamant.com](http://www.daniamant.com)) or on request.

## Product Disposal Instructions

Daniamant's Survivor Location Lights contain batteries as well as electrical and electronic components, and must therefore be segregated from the domestic waste stream and recycled. Disposing of this product correctly will help save valuable resources and prevent any potential negative effects on human health and the environment, which could otherwise arise from inappropriate waste handling. Daniamant's lights are marked with the symbol below which conveys that this waste must be treated separately from household waste.

To ensure compliance with the WEEE and Battery Regulations, the Survivor Location Lights placed on the market in the UK or Denmark should be returned to Daniamant in the UK or Denmark, or deposited in your nearest WEEE Designated Collection Facility, operated by your Local Authority.



Further copies of this installation and maintenance instructions are available to download from our website [www.daniamant.com](http://www.daniamant.com)  
A copy of these instructions must be held with the ships/owners training manual.